

1 Helena Court £295,000

Rue Du Rocher, Blanchelande Park, St. Martin, GY4 6EN | Local Market | TRP 68

 x 1  x 1  x 1





Property Overview

A one bedroom ground floor flat in the desirable parish of St Martin in a stunning location with communal gardens, allocated parking and stunning views.

 One bedroom ground floor flat

 Leasehold

 Views over large communal gardens

 Highly regarded over 55's development at Blanchelande Park

 Allocated parking and plenty of visitors parking

 No onward chain



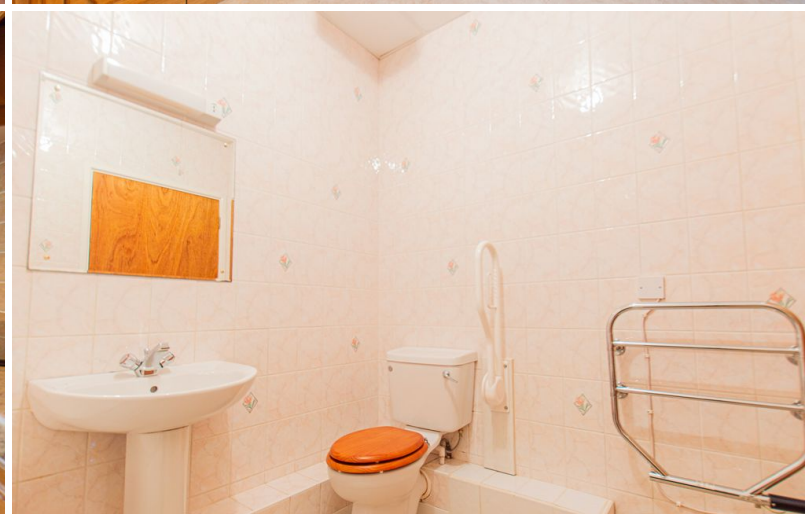

About 1 Helena Court

This spacious ground floor, one bedroom flat, is in the sought after over 55's development at Blanchelande Park. Flat 1, Helena Court comprises a hallway, kitchen, lounge, double bedroom and bathroom.

Externally, there are wonderful views over the delightful and extensive communal gardens, along with designated parking for one vehicle immediately to the front of the property and ample parking for visitors. The lease has 104 years remaining.

The quarterly service charge is £819.31 and provides maintenance of the building, lift, communal lighting and gardens. Please note that water and electricity charges are not covered in the quarter service charge.

This property is in a safe gated community for the over 55's whom can live independently but still have company from other residents should they wish to mingle.

Viewing highly recommended.

Floor Plan

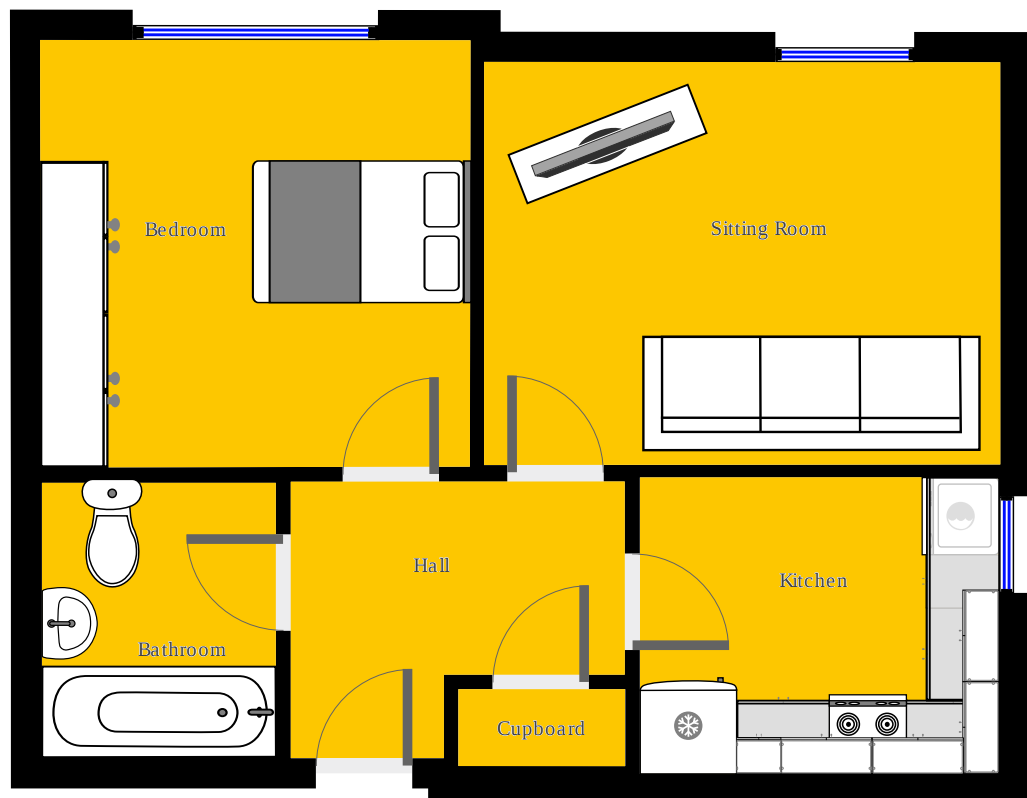

THIS FLOORPLAN IS PROVIDED WITHOUT WARRANTY OF ANY KIND. SENSOPIA DISCLAIMS ANY WARRANTY INCLUDING, WITHOUT LIMITATION, SATISFACTORY QUALITY OR ACCURACY OF DIMENSIONS.

1 Helena Court

Bedroom: 3.53m x 3.57m (11'5 x 11'7)

Bathroom: 1.94m x 2.27m (6'4 x 7'4)

Hall: 2.77m max x 1.6m min x 2.29m max x 1.27m min (9'1 x 5'2 x 7'5 x 4'2)

Lounge: 3.33m x 4.28m (10'9 x 14')

Kitchen : 2.98m x 2.46m (9'7 x 8'1)

Appliances

Hotpoint washer dryer, Firenzi dishwasher (non operational), Firenzi oven (non operational), Caren hob, Firenzi extractor, Hotpoint fridge freezer

Services

Mains electricity and water

Heating

Electric night storage heaters

Drainage

Mains drain

What3words

///alarming.roadways.streetlight

Viewing and possession

By appointment and arrangement through Sheppards Estate Agents only

These particulars, whilst believed to be accurate are set out as a general outline only for guidance and do not constitute any part of an offer or contract. Sketch and 3D plans are for illustrative purposes only. All measurements, walls, doors, windows, fittings and appliances, their sizes and locations are shown conventionally and are approximate only and cannot be regarded as being a representation either by the Vendor or their Agent, SEA Limited trading as Sheppards Estate Agents. Intending purchasers should not rely on them as statements or representations of fact or that the property or its services or any systems or equipment are in good condition, but must satisfy themselves by inspection or otherwise as to their accuracy and operative condition. Any reference to alterations to, or use of, any part of the property is not a statement that any necessary planning, building regulations or other consent has been obtained. These matters must be verified by any intending purchaser. No person in this firms employment has the authority to make or give any representation or warranty in respect of the property.